



OVER 600 PADEL  
COURTS ALREADY  
COVERED IN ITALY



**ECOVER**

SISTEMI DI COPERTURA

**PADEL SOLUTION**

A wide-angle photograph of an indoor padel court. The court features a vibrant red floor and is enclosed by high glass walls supported by a black metal frame. The ceiling is a complex network of white structural beams. In the background, several courts are visible, each marked with a number (2, 3, 4, 5). A person in a yellow shirt is seen playing on one of the courts in the distance.

# ALL THE SOLUTIONS TO COVER YOUR PADEL COURT

We'll take care of the coverage,  
with a wide choice of available solutions.



# SINGLE PADEL COURT

Quick and streamlined solution to get up and running with a coverage that guarantees comfort, playability and safety at the highest levels.

**Available dimensions (m):**

11.6x22x9.7 | 13.2x22x9.2 | 15.2x22x9.2

Height of fully opening and panoramic perimeter curtains: 4.5m

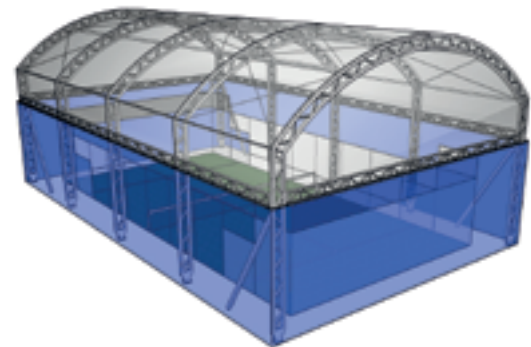



# 2/3 PADEL COURTS

The first step towards a great sports club.  
The coverage that gives panoramcity, functionability, fruicionability  
ensuring to host your first real tournaments.

## Available dimensions (m):

13.2x44.1x9.2 | 15x43x9.2 | 22x24x11 | 24x29x11 | 24x39x11 | 24x45x11

Height of fully opening and panoramic perimeter curtains: 4.1 m

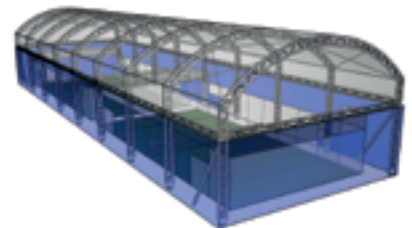
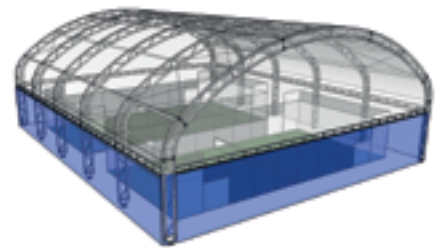

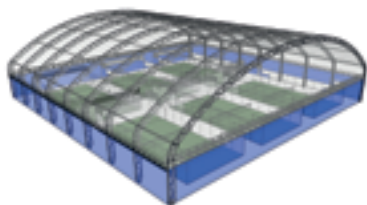
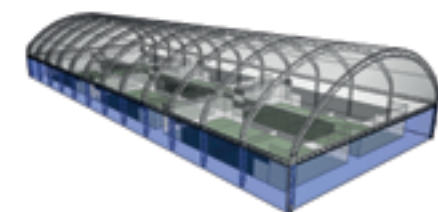

# LARGE SPORTS CLUB

The definitive Padel Club needs performance  
unique and with "tailored" coverage.  
A single structure that accommodates all your courts.

## **Available dimensions (m):**

24x56x11.425 | 24x63x11.425 | 24x75x11.425 | 24x56x11.425 | 27x46x12 | 30x46x12

Height of fully opening and panoramic perimeter curtains: 4.1 m



DETAILS THAT  
MAKE  
THE DIFFERENCE

### **DOUBLE/TRIPLE VENTILATED PVC COVER**

Main advantages of the double membrane sheet:

Reduction of the "condensation" phenomenon

Reduction of heating consumption

Lower heat transmittance inside the roof in the summer months.

### **TRASLUCENT BAND**

Translucent band on the roof which allows for an increase in natural lighting, creating a slice of sky in the center of the structure.

### **NATURAL LIGHTING**

Our highly resistant sheets are able to filter natural light in order to take advantage of the daylight hours, to have constant and precise lighting and at the same time eliminating the annoying phenomenon of glare during the game.

### **HEATING SYSTEMS**

Spaces for sports and leisure activities require heating systems that ensure maximum management flexibility. Ideal for these systems are modular heating units, boiler systems with standard air heaters or electronic air heaters.

# COMFORT AT THE TOP

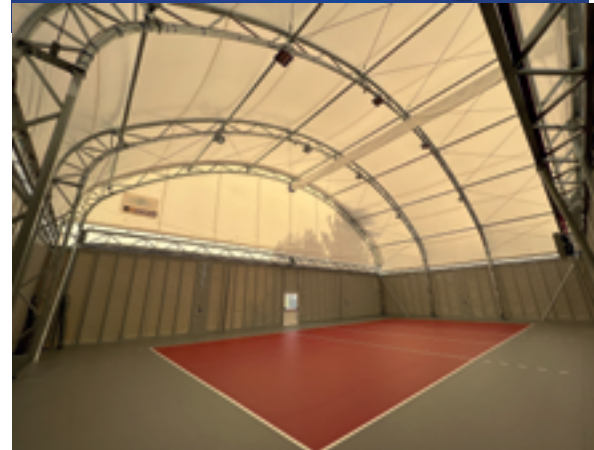

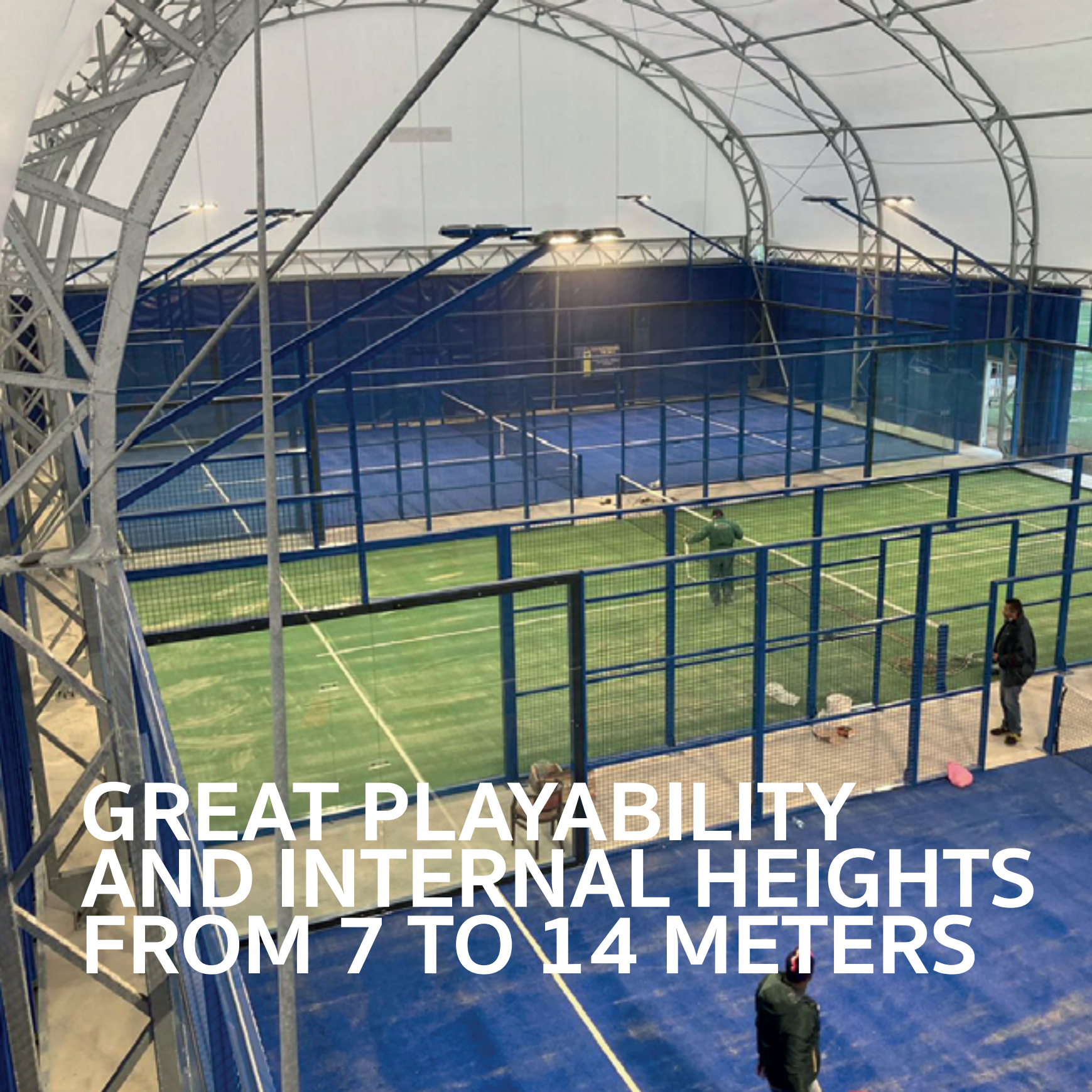

**GREAT PLAYABILITY  
AND INTERNAL HEIGHTS  
FROM 7 TO 14 METERS**

## **POLYESTER MEMBRANES AND FABRICS**

Membranes are so important structural elements of our roofs.

The sheets are made from a waterproof PVC membrane which offers high resistance performance, versatility and durability.

Polyester fabrics are able to absorb considerable forces at the same light weight.

The PVC treatment, with the coating on both sides (double-coated), gives high stability to UV rays and combats the formation of fungi and mould.

## **HIGHLY RESISTANT STRUCTURE**

The load-bearing structure of the roof is light but extremely resistant.

Ecover covers are studied and designed specifically for each installation site, ensuring stability and safety in any climatic condition.

## **LOAD-BEARING STRUCTURE MADE OF GALVANIZED STEEL**

Arches with straight vertical uprights made with tubular profile trusses.

Spacers beams between arch and arch made of tubular profile.

Round steel bracings for head stiffening to increase stability and stability structural cohesion.

Perimeter beams made with a three-dimensional tubular profile truss to perform the double function of fixing the sliding curtain walls and tensioning the covering sheet.



# ESSENTIAL ACCESSORIES

Ecover covers optimize internal spaces at maximum. Completely customizable, with different accessories, to make the product unique.

## SLIDING CURTAINS HIGH PERIMETERS UP TO 4500 MM

The easy movement and height of the curtains allow for internal air movement in just a few minutes which generates environmental well-being even during the hottest summer hours.

## PAINTINGS

Complete customization of the painted roof high resistance for all structural parts.

## PEDESTRIAN DOOR

Door for pedestrian access anodized aluminium, with panel upper part in high-resistance translucent polycarbonate, with one or two doors and with handle anti-panic for opening towards the outside.

## INTEGRATED SEAT

Integrated customizable seating system for better liveability for spectators.



A black padel racket is leaning against a chain-link fence on a green artificial turf court. The sun is setting in the background, creating a warm, golden glow. The racket has a black frame and a black head with a grid of holes. The fence is made of chain-link mesh and runs along the side of the court. The court surface is green artificial turf. A yellow tennis ball is visible in the foreground on the turf.

# PLAY PADEL, 365 DAYS A YEAR!

Our covers allow you to have  
a playable structure in every season and weather condition.



# ECOVER

SISTEMI DI COPERTURA

PADEL COURT COVERS  
TENNIS COURT COVERS  
SPORTS COVERS  
INDUSTRIAL ROOFS

WE MAKE STEEL  
OR LAMINATED WOOD COVERINGS

**Ecover Srl**

Operational Headquarters:

Via Fosso Foreste, 8

65015 Montesilvano | Pescara | ITALY

Tel: +390852012216

[www.ecoversrl.com](http://www.ecoversrl.com) | [info@ecoversrl.com](mailto:info@ecoversrl.com)

